

CISCO LYNKSYS WI-FI ROUTER

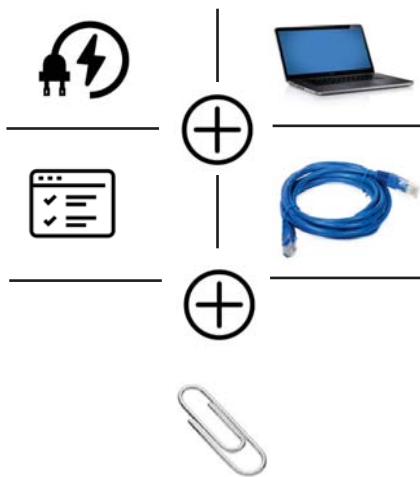

CISCO LYNKSYS WET610 & WES610 WI-FI ROUTER INSTALLATION PREPARATION

In addition to a Linksys router with its power source, you will need a laptop with an Ethernet connectivity test preloaded, an Ethernet cable and a paper clip.



SET-UP INSTRUCTIONS:

1. CONNECT & POWER UP THE ROUTER

Connect power & Ethernet cords into Linksys device

2. CONNECT TO LAPTOP

Connect other end of Ethernet cord into laptop

3. CLEAR ANY EXISTING WI-FI CONNECTIONS

Disconnect from any Wi-Fi connections on laptop, or disable Wi-Fi

4. RESET THE ROUTER

Reset your Linksys with a paper clip, hold down for approximately 10 seconds

Wait 1-3 minutes until lights on Linksys are solid

4. OPEN A BROWSER ON THE LAPTOP AND TYPE IN THE ROUTER'S IP ADDRESS

Open up a browser on your laptop, preferably Chrome or Firefox

Type in **169.254.1.250** in the address bar and press enter

5. ENTER USER NAME AND PASSWORD

When prompted, **leave the user name blank**, and enter **admin** as password

6. SELECT WIRELESS TAB

When Interface page appears, click on Wireless Tab

7. SELECT WIRELESS SITE SURVEY TAB

Click on **Wireless Site Survey Tab** and wait for networks available to load

8. FIND YOUR DESIGNATED NETWORK

Connect to **designated network** with the highest percentage, i.e. HHONORS – 60%

9. LOOK FOR A CONNECTION

If successful, a "Connected" page will display

10. NO CONNECTION? NEXT STEPS:

If a **"Connected"** page does not appear follow directions below. Repeat steps 4-9 above

Connect to a network with the second highest percentage

If still not successful, try the third, and fourth percentage

Call VisitorFun after fourth unsuccessful attempt

Wireless		Setup	Wireless	Administration	Status
		Basic Wireless Settings	Wireless Network Site Survey	WMM/0	Advanced Wireless Settings
Wireless Network Site Survey					
Number of Wireless Networks: 18					
Select	Wireless Network Name	GHz	Signal	Security	
<input type="radio"/>	IED-Sciesia	2.4	0%	WPA2 Enterprise	
<input type="radio"/>	Studio Legale	2.4	0%	WPA2 Personal	
<input type="radio"/>	FASTWEB-1-001D6B480D58	2.4	25%	WPA Personal	